

INSTALLATION & USE OF DIAMOND PLATE KIT

The optional diamond plate kit (PN: DP-4000) is used on heavy duty springs, or where the assembly is not able to be properly installed into the unit using the upper and lower claw hooks.

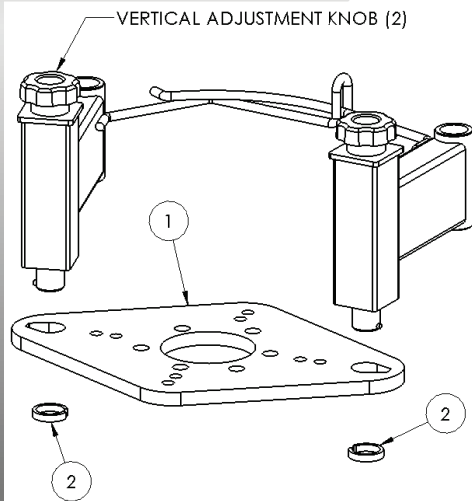

WHILE HOLDING THE DIAMOND PLATE (ITEM #1) IN PLACE, ALIGN OPENING IN ITEM #2 WITH BOSS ON THE SHAFT OF THE VERTICAL ADJUSTMENT ARM. LIFT ITEM #2 INTO PLACE BELOW THE DIAMOND PLATE THEN ROTATE 180° SO THAT THE OPENING NO LONGER ALIGNS WITH BOSS.

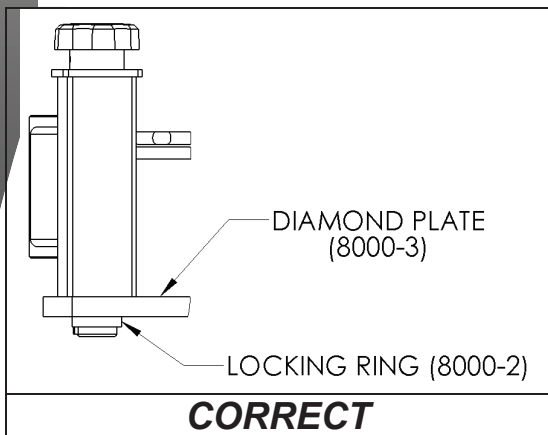

AFTER INSTALLING BOTH LOCKING RINGS, ENSURE THAT THE DIAMOND PLATE IS DRAWN TIGHTLY TO THE VERTICAL ADJUSTMENT ARMS WITH NO GAPS

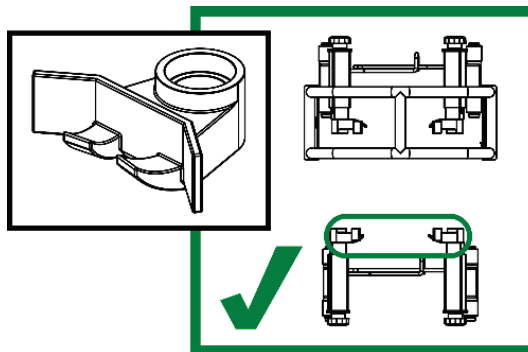
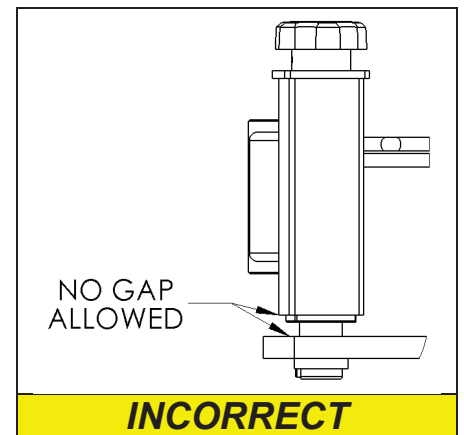

Continued on next page...

INSTALLATION & USE OF DIAMOND PLATE KIT (continued...)

The optional diamond plate kit (PN: DP-4000) is used on heavy duty springs, or where the assembly is not able to be properly installed into the unit using the upper and lower claw hooks.

Double check that the diamond plate is drawn tight to the upper arms using the vertical adjustment knobs.

Install a double claw hook on each of the lower two arms.

Position the strut assembly onto the lower arms using the vertical adjustment knobs to orient the strut assembly in a vertical position.

If the strut assembly has studs that do not align with a pattern in the diamond plate, install the diamond plate stud spacers over the studs on the strut assembly.

Slowly raise the strut into position with the compressor and once the top end (or stud spacers) contacts the diamond plate, verify that both lower double claw hooks are contacting the spring.

Install (4) custom placement pins to secure the top end of the assembly & prevent it from moving under compression.

Compress the strut assembly.

Position the strut support weldment (third hand) under the assembly to hold it in place.

Remove the fastener from the top of the unit and lower the strut compressor relieving the spring.

Reverse steps to reassemble.

